

KSDD90VN-2



Product family	Hood
Hood Type	DownDraft
Design	Fully integrated
Extraction	Extraction
Electronic control	Yes
Perimeter extraction	Yes
Material	Stainless Steel + Glass
Type of steel	Brushed
EAN code	8017709239336
Hood width	90 cm
Aesthetic	Dolce Stil Novo
Colour	Black
Finishing	Glass
Glass Type	Black
Serigraphy colour	White
Logo	Silk screen



Controls

Control setting	Remote Control
-----------------	----------------

Program / Functions

No. of speeds	3
Intensive speed	
Time-setting options	

Technical Features



Remote motor	Included	Motor power	285 W
No. of lights	1	No. of filters	2
Light type	LED	Anti-grease filters	stainless steel 7 layer
Light Power	6 W	Vent outlet	150 mm
Light color temperature scale (K)	4000 K	Non return valve	Yes
Free outlet maximum capacity	800 m ³ /h		

Extraction rate IEC
61591 [m³/h]

Noise level IEC 60704-
2-13 [dBA]

Speed 1	230	42
Speed 2	322	50
Speed 3	500	59
Intensive speed	730	66

Accessories included

Remote control	Yes	Motorised opening	Yes
----------------	-----	-------------------	-----

Performance / Energy Label





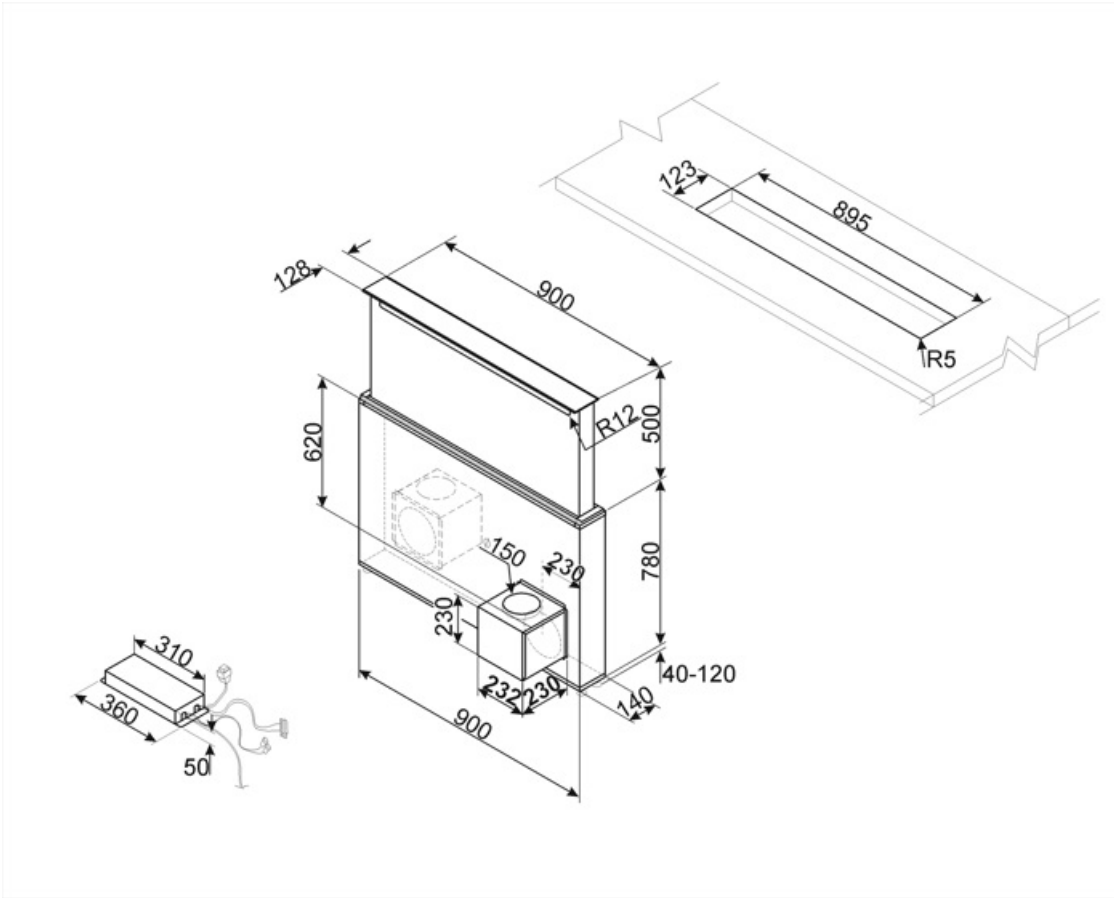

Annual Efficiency Consumption (AEChood)	60 kWh/a	Airbourne acoustical A-weighted sound Power Emission at minimum speed (SPEmin)	40 dBA
Energy efficiency class (EEC)	A	Airborne acoustical A-weighted sound Power Emission at maximum speed (SPEmax)	57 dBA
Fluid Dynamic Efficiency (FDE)	29,5	Airbourne acoustical A-weighted sound power emission at boost speed (SPEboost)	65 dBA
Fluid Dynamic Efficiency class (FDEC)	A	Time increase factor (F)	1,00
Lighting Efficiency (LE)	15,0 lux/W	Energy Efficiency Index	53,1
Lighting Efficiency Class (LEC)	D	Measured air flow rate at best efficiency point (Qbep)	349 m ³ /h
Grease Filtering Efficiency (GFE)	38,9 %	Measured air pressure at best efficiency point (Pbep)	464 Pa
Grease Filtering Efficiency Class (GFEC)	G	Measured electric power input at best efficiency point (Wbep)	147 W
Air flow at mininum speed (Qmin)	213 m ³ /h	Nominal Power consumption of the light system (WL)	6 W
Air flow at maximum speed (Qmax)	448 m ³ /h	Average illumination of the light on the cooking surface (Emiddle)	253 lux
Air flow at boost speed (Qboost)	724 m ³ /h	Sound power level at highest setting (Lwa)	57 dBA

Electrical Connection

Electrical connection rating	292 W	Power supply cable length	1000 mm
Voltage	220-240 V	Plug	Not present
Frequency (Hz)	50-60 Hz		

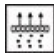

Symbols glossary

- | | | | |
|--|--|---|---|
|  | Energy efficiency class A |  | Filters: Model has filters to help remove grease from the steam emanating from the pans during cooking. |
|  | Switch off automatically: A special setting, to run after the end of cooking for a pre-set time and then switch off automatically. |  | Lights: All cooker hoods feature lights to illuminate the cooking area or add to the ambience of the kitchen. |
|  | Perimeter extraction panels: very efficient and aid noise reduction. |  | Intensive/turbo setting: when extra fast extraction is required. |