

# KSET600XE

Product family	Hood
Hood Type	Integrated (semi) hood
Design	Telescopic
Extraction	Extraction
Material	Stainless steel
Type of steel	Brushed
EAN code	8017709205362
Aesthetic	Universale
Colour	Stainless steel
Finishing	Satin
Serigraphy colour	Black
Logo	Silk screen

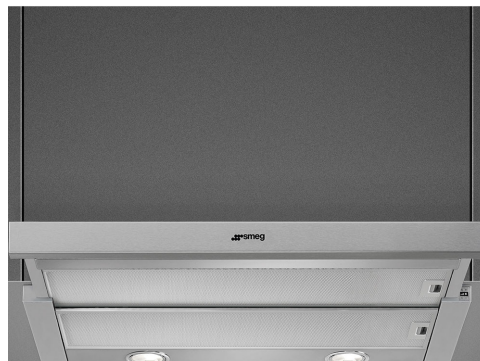

## Controls

Control setting	Slider
-----------------	--------

## Program / Functions

No. of speeds	3
---------------	---

## Technical Features

			
No. of lights	2	No. of filters	2
Light type	LED	Anti-grease filters	Aluminium
Light Power	3 W	Vent outlet	150 mm
Light color temperature scale (°K)	3500 °K	Minimum distance from GAS hob	650 mm
Free outlet maximum capacity	603 m³/h	Minimum distance from ELECTRIC hob	500 mm
Motor power	175 W	Non return valve	Yes

	Extraction rate IEC 61591 [m³/h]	Noise level IEC 60704-2-13 [dBA]
Speed 1	240	44
Speed 2	368	54

Speed 3	581	65
------------	-----	----

## Performance / Energy Label



Annual Efficiency Consumption (AEChood)	75 kWh/a
Energy efficiency class (EEC)	B
Fluid Dynamic Efficiency (FDE)	21
Fluid Dynamic Efficiency class (FDEC)	C
Lighting Efficiency (LE)	76,1 lux/W
Lighting Efficiency Class (LEC)	A
Grease Filtering Efficiency (GFE)	76 %
Grease Filtering Efficiency Class (GFEC)	C
Air flow at minumum speed (Qmin)	240 m³/h
Air flow at maximum speed (Qmax)	581 m³/h

Airbourne acouistical A-weighted sound Power Emission at minimum speed (SPEmin)	44 dBA
Airborne acouistical A-weighted sound Power Emission at maximum speed (SPEmax)	65 dBA
Time increase factor (F)	1,2
Energy Efficiency Index	69,4
Measured air flow rate at best efficiency point (Qbep)	352 m³/h
Measured air pressure at best efficiency point (Pbep)	354 Pa
Measured electric power input at best efficiency point (Wbep)	165 W
Nominal Power consumption of the light system (WL)	4 W
Average illumination of the light on the cooking surface (Emiddle)	304 lux
Sound power level at highest setting (Lwa)	65 dBA

## Electrical Connection

Plug	Not present	Frequency (Hz)	50-60 Hz
Electrical connection rating	181 W	Power supply cable length	1500 mm
Voltage	220-240 V		

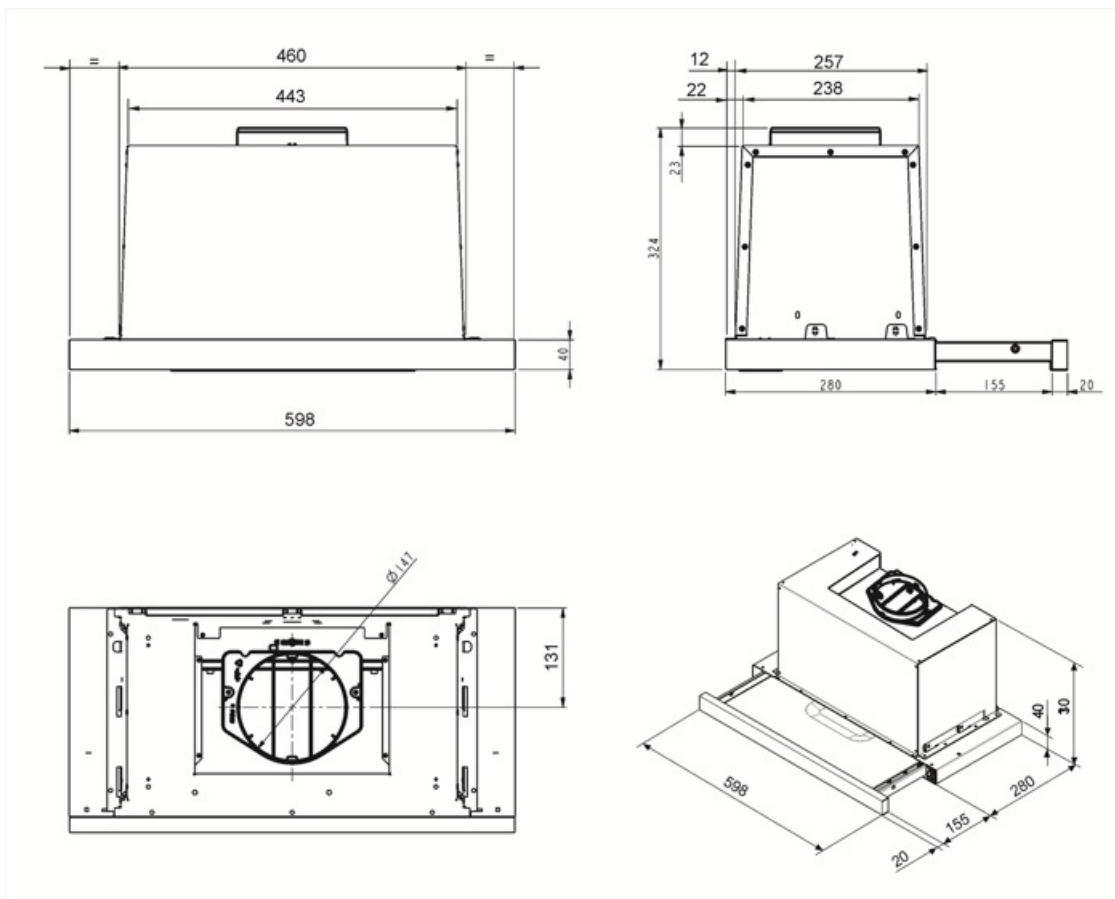

---

## Compatible Accessories

---



**KITFC500**

Round Charcoal filters (kit 2 pieces)

---

## Symbols glossary

---



Filters: Model has filters to help remove grease from the steam emanating from the pans during cooking.



Lights: All cooker hoods feature lights to illuminate the cooking area or add to the ambience of the kitchen.