

LG861S-2

Sink material	Stainless steel
Sink type	Welded
No. of bowls	1
Drainer	Left
EAN code	8017709198510



Aesthetics



Aesthetics	Universal	Building in type	Ultra-low profile
Series	Alba	Logo	Embossed
Colour	Stainless steel	Tap hole / precut tap hole	1 Tap hole
Finishing	Brushed		

	Bowl type	Bowl thickness (mm)	Bowl dimensions, WxDxH (mm)	Bowl depth (mm)	Radius corner right bowl (mm)	Overflow	Strainer position	Strainer dimension
RH Bowl	Traditional	0.7	450 x 400 x 210	210	80	Yes, traditional	Side bowl	3.5"

Technical Features



Frame thickness	0,7 mm	Tap hole	1
Frame depth (mm)	15	Tap hole diameter	35 mm
Dimensions of the product WxDxH (mm)	220x860x500 mm	Drainer inclination	2 °
Cutout dimension (mm)	840 x 480 mm	Gasket type	Sealing paste
Cutout radius	10 mm	No. of clips	8
Height from kitchen top	6 mm	Type of clips	Standard
Base unit size	60 cm		

Accessories Included

Accessories for installation

Strainer, Siphon with dishwasher outlet connection, Fixing clips, Gasket

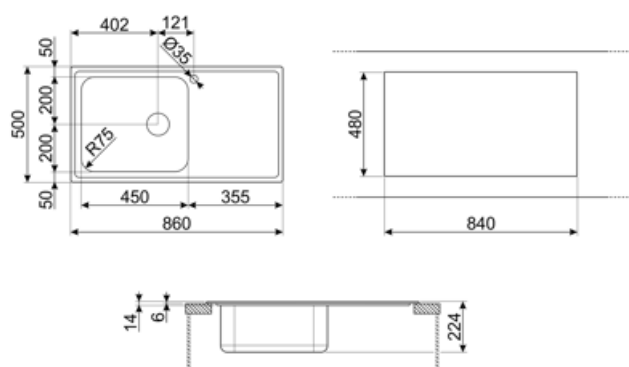

Compatible Accessories



KITFD050

Waste disposal 0,5 HP Motor: 1/2 horsepower Fits all sinks with 3 1/2" waste outlet



KITFD100

Waste disposal 1 HP Motor: 1 horsepower Fits all sinks with 3 1/2" waste outlet



STABMIX

Tap brace



KITFD075

Waste disposal 0,75 HP Motor: 3/4 horsepower Fits all sinks with 3 1/2" waste outlet



RND1V

Rondò waste kit 1 bowl with standard overflow

Symbols glossary



Cupboard width required for sink installation



Sink depth - depending on the model, the depth can be from 13 to 24,5



Ultra-low profile: Installation of product with flat edge - height of 1 mm.

Benefit

One bowl

A single bowl for greater adaptability, capacity and space optimisation

Drainer

The drainer provides a convenient space for dishes, cutlery, and kitchen utensils to dry naturally by allowing excess water to flow directly into the sink.

Tap hole

The sink offers the option of pre-cut tap holes, allowing for direct tap installation and creating a more spacious, streamlined surface.