

PX375MB

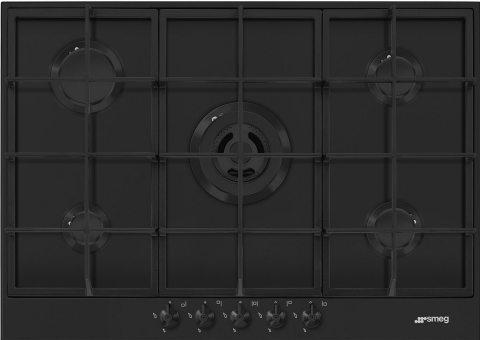

Product Family	Hob
Built-in type	Traditional
Dimensions	70/75 cm
Power supply	Gas
Type	Gas
EAN code	8017709321628



Aesthetics



Aesthetic	Classic
Colour	Matt Black
Finishing	Matt black
Material	Enamelled
Serie	New
Pan stands	Cast iron
Burners	Smeg Contemporary
Burners Material	Alluminium
Burner Coating	Black Ceram
Type of control setting	Control knobs
Control knob position	Front
No. of controls	5
Controls colour	Matt Black
Serigraphy colour	Silver

Programs / Functions

Total no. of cook zones	5
No. of gas cook zones	5

Options



Standard cut out	478-482x555-560 mm
------------------	--------------------

Technical Features

UR

Front-left - Gas - AUX - 1.10 kW

Rear-left - Gas - Rapid - 2.60 kW

Central - Gas - UR - 4.00 kW

Rear-right - Gas - Semi Rapid - 1.80 kW

Front-right - Gas - Semi Rapid - 1.80 kW

Gas safety valves	Yes	Automatic Ignition	Yes
--------------------------	-----	---------------------------	-----

Electrical Connection

Electrical connection rating (W)	1 W	Frequency (Hz)	50/60 Hz
Voltage (V)	220-240 V	Power supply cable length	120 cm
Type of electric cable	Single phase		

Gas Connection

Gas Type	G20 Natural gas	Other gas connections provided	Conical
Gas connection	Cilindrica	Gas connection rating (W)	11300 W
Other gas nozzles included	G30 GPL Liquid gas		

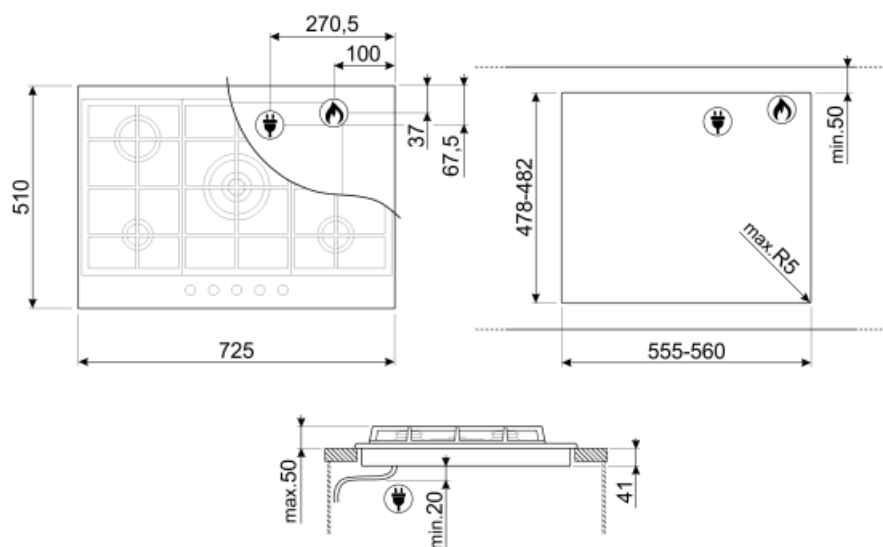

Not included accessories

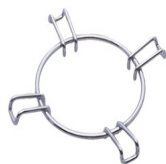

GRW
Wok support



WOKGHU
Cast-Iron WOK Support



TPK
Stainless steel grill plate to cook
Teppanyaki dishes

Symbols glossary (TT)



Standard installation: Traditional installation in tabletop, suitable for any kitchen sets



Heavy duty cast iron pan stands: for maximum stability and strength.



CUT_OUT_STANDARD_72dpi



Ultra rapid burners: Powerful ultra rapid burners offer up to 5kw of power.



Knobs control