

UM15

Sink material

Type

No. of bowls

EAN code

Stainless steel

Monoblock bowl

1

8017709209162



Aesthetics



Aesthetic

Series

Colour

Universale

Alba

Stainless steel

Finishing

Building in type

Logo

Brushed

Undermount

Not present

	Bowl type	Bowl dimensions, WxDxH (mm)	Bowl depth (mm)	Radius corner bowl	Strainer position	Strainer dimension
Bowl	Half bowl	147 x 296 x 150	150	50	Centre of bowl	3.5"

Technical Features



Dimensions of the product (mm)

Cutout dimension undermount (mm)

Base unit size

150x318x168 mm

155x304 mm

30 cm

Tap hole diameter

No. of clips

Type of clips

35 mm

4

Undermount clip

Accessories Included

Accessories for installation

Strainer, Fixing clips

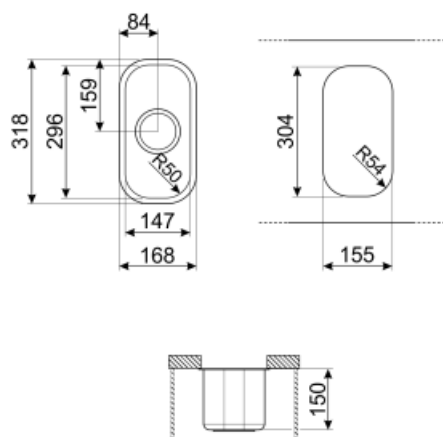

Not included accessories



KITFD050

Waste disposal 0,5 HP, Motor: 1/2 horsepower, Fits all sinks with 3 1/2" waste outlet



KITFD100

Waste disposal 1 HP, Motor: 1/2 horsepower, Fits all sinks with 3 1/2" waste outlet



3712

Siphon single bowl sinks (dishwasher connection included)



3713

Siphon double bowls sinks (dishwasher connection included)



KITFD075

Waste disposal 0,75 HP, Motor: 1/2 horsepower, Fits all sinks with 3 1/2" waste outlet

Symbols glossary (TT)



Cupboard width required for sink installation



Sink depth - depending on the model, the depth can be from 13 to 24,5



Under table top installation: The sink is fixed under tabletop, which extends the work surface and the depth of the sink.