

VFU43SFR

Sink material

Type

No. of bowls

EAN code

Stainless steel

Monoblock bowl

1

8017709304584



Aesthetics



Aesthetic

Series

Colour

Finishing

Universale

Omni

Stainless steel

Brushed

Building in type

Logo

Tap hole / precut tap hole

Standard, Undermount

Not present

No Taphole

	Bowl type	Bowl dimensions, WxDxH (mm)	Bowl depth (mm)	Overflow	Strainer position	Strainer dimension
Bowl	Round	diametro 375	200	Yes, traditional	Wall position	3.5"

Technical Features



Dimensions of the product (mm)

Cutout dimension topmount (mm)

Cutout dimension undermount (mm)

Height from kitchen top

Base unit size

200x430x430 mm

410 mm

374 mm

6 mm

45 cm

Tap hole diameter

Gasket type

No. of clips

Type of clips

35 mm

Sealing paste

3

Standard + undermount clip

Accessories Included

## Accessories for installation

Strainer, Fixing clips,  
Gasket

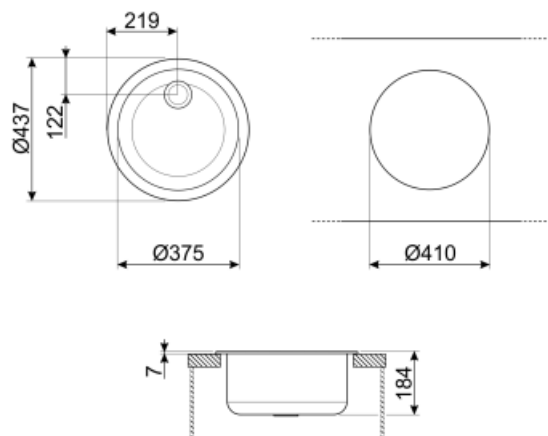

---

## Not included accessories

---



### RND1V

Rondò waste kit 1 bowl with standard overflow



### KITFD100

Waste disposal 1 HP, Motor: 1/2 horsepower, Fits all sinks with 3 1/2" waste outlet



### 3713

Siphon double bowls sinks (dishwasher connection included)



### KITFD075

Waste disposal 0,75 HP, Motor: 1/2 horsepower, Fits all sinks with 3 1/2" waste outlet



### KITFD050

Waste disposal 0,5 HP, Motor: 1/2 horsepower, Fits all sinks with 3 1/2" waste outlet



### 3712

Siphon single bowl sinks (dishwasher connection included)





### KITDS

Soap dispenser chrome finishing with round knob

---

## Symbols glossary (TT)

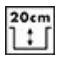
---

	Cupboard width required for sink installation		Sink depth - depending on the model, the depth can be from 13 to 24,5
	Standard installation: Traditional installation in tabletop, suitable for any kitchen sets		Under table top installation: The sink is fixed under tabletop, which extends the work surface and the depth of the sink.