

# VSTQ50-2

Sink material	Stainless steel
Type	Squared bowl
No. of bowls	1
EAN code	8017709127732



## Aesthetics



Aesthetic	Universale	Finishing	Brushed
Series	Quadra	Building in type	Undermount
Colour	Stainless steel	Logo	Embossed

	Bowl type	Bowl dimensions, WxDxH (mm)	Bowl depth (mm)	Overflow	Strainer position	Strainer dimension
Bowl	Squared	500 x 400 x 210	210	Yes, traditional	Wall position	3.5"

## Technical Features



Dimensions of the product (mm)	210x520x418 mm	Gasket type	Sealing paste
Cutout dimension undermount (mm)	398*500 mm	No. of clips	6
Base unit size	60 cm	Type of clips	Undermount clip
Tap hole diameter	35 mm		

## Accessories included

Accessories for installation	Strainer, Savespace siphon with dishwasher outlet connection, Fixing clips
------------------------------	--

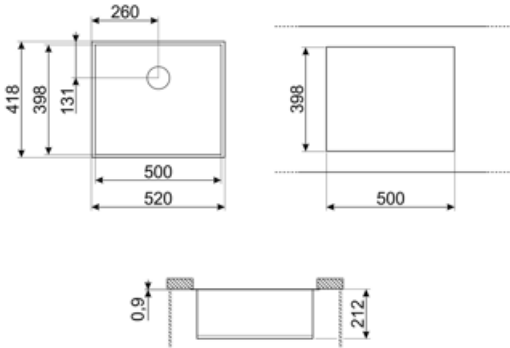

---

## Compatible Accessories

---



**3712**

Siphon single bowl sinks (dishwasher connection included)



**KITFD050**

Waste disposal 0,5 HP, Motor: 1/2 horsepower, Fits all sinks with 3 1/2" waste outlet



**KITFD100**

Waste disposal 1 HP, Motor: 1/2 horsepower, Fits all sinks with 3 1/2" waste outlet



**VSH20Q**

Colander for square sinks radius 0 204 x 438 x 118 mm



**3713**

Siphon double bowls sinks (dishwasher connection included)



**KITFD075**

Waste disposal 0,75 HP, Motor: 1/2 horsepower, Fits all sinks with 3 1/2" waste outlet



**RND1V**

Rondò waste kit 1 bowl with standard overflow

---

## Symbols glossary

---



Cupboard width required for sink installation



Sink depth - depending on the model, the depth can be from 13 to 24,5



Under table top installation: The sink is fixed under tabletop, which extends the work surface and the depth of the sink.

---

## Benefit (TT)

---

### **One bowl**

A single bowl for greater adaptability, capacity and space optimisation