

VSTR34BRX

Sink material Stainless steel
Type Monoblock bowl
No. of bowls 1
EAN code 8017709303006



Aesthetics



Aesthetic Universale
Series Mira
Colour Brass
Finishing PVD Brushed
Building in type Undermount
Logo Embossed
Tap hole / precut tap hole No Taphole

	Bowl type	Bowl dimensions, WxDxH (mm)	Bowl depth (mm)	Radius corner bowl	Overflow	Strainer position	Strainer dimension
Bowl	Minimum radius	340 x 400 x 200	200	15	Yes, flush fitted	Wall position	3.5"

Technical Features



Characteristics PVD coating Coating thickness , Eco-friendly, Easy to clean, Hypoallergenic
Dimensions of the product (mm) 200x382x442 mm
Cutout dimension undermount (mm) 344*404 mm
Base unit size 45 cm
Tap hole diameter 35 mm
No. of clips 4
Type of clips Undermount clip

Accessories Included

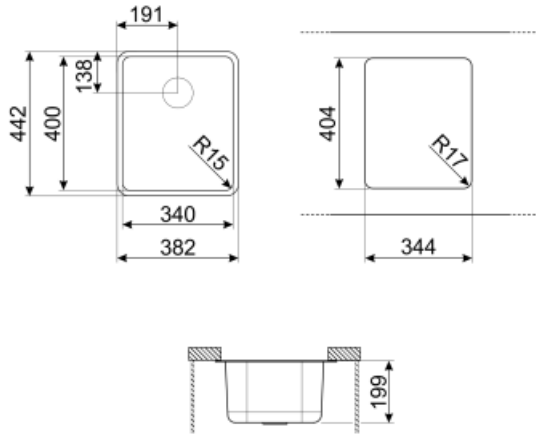

Not included accessories



KITFD050

Waste disposal 0,5 HP, Motor: 1/2 horsepower, Fits all sinks with 3 1/2" waste outlet



KITFD100

Waste disposal 1 HP, Motor: 1/2 horsepower, Fits all sinks with 3 1/2" waste outlet



DB34

St/steel drain basket to fit STD radius 340 x 400 bowl, 180 mm depth



3712

Siphon single bowl sinks (dishwasher connection included)



3713







Siphon double bowls sinks (dishwasher connection included)

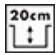

KITFD075

Waste disposal 0,75 HP, Motor: 1/2 horsepower, Fits all sinks with 3 1/2" waste outlet

Symbols glossary (TT)

- | | | | |
|--|---|---|---|
|  | Cupboard width required for sink installation |  | Sink depth - depending on the model, the depth can be from 13 to 24,5 |
|  | Under table top installation: The sink is fixed under tabletop, which extends the work surface and the depth of the sink. |  | Easy to clean |
|  | Coating thickness between 0.2mm and 2mm |  | PVD coatings are hypoallergenic and suitable for use in contact with food |
|  | The manufacturing process of PVD treatment is 100% green and eco-friendly | | |